

MUSTANG SURVIVAL
INFLATABLE VEST
WITH LIFT™



Owner's Manual

MD0450 22 Inflatable Vest with LIFT™

Hydrostatic Inflation Model - Manual with Automatic Backup

SecureZIP™ US Patent No. 6,832,415 and Patents Pending



CONTENTS

Page	1 Introduction
	1 Why are PFDs Required Safety Equipment?
	2 What is an Inflatable PFD?
	3 Instructions for Use
	3 Component Inspection Instructions
	4 Readiness Checklist
	5 Donning Instructions
	6 Inflation
	8 In-water Adjustments
	9 Special Considerations for Automatic Devices
	10 Deflation
	10 Usage Below Freezing
	11 Re-arming Your PFD
	15 Auto/Manual Conversion Cap (MA7219) Instructions
	15 Conversion Instructions
	17 Repacking
	23 Is Your PFD in Good and Serviceable Condition?
	24 Care and Maintenance Instructions
	26 Cleaning and Storing
	26 How and Why to Test Your PFD
	27 How Do You Test Your PFD Using the Automatic Inflator?
	27 How Do You Test Your PFD Using the Manual Inflator?
	28 How Do You Test Your PFD Using the Oral Inflator?
	29 Wear Your PFD
	30 Hypothermia
	31 Each of These Devices is Intended to Help You Save Your Life
	32 Safety Accessories
	32 Do Not Attach PFDs to Your Boat
	32 Airline Operator Policy on Carriage of Inflatable PFDs

INTRODUCTION

The MD0450 22 requires user involvement to ensure a level of safety equal to other inflatable PFDs. Knowledgeable users increase their safety significantly by wearing and using these PFDs as prescribed in this owner's manual.

General - This Inflatable PFD will turn most wearers from a face down to a face up position and provide support suitable for offshore conditions. See page 11 for re-arming instructions.

This Inflatable PFD was designed to be more comfortable and less restrictive to wear than inherently buoyant PFDs. When worn, used and serviced according to this owner's manual, this PFD can greatly increase your chances of survival in the water. **Not recommended for non-swimmers or weak swimmers.**

To be considered serviceable, this PFD shall not exhibit deterioration that could diminish its performance such as broken or deformed hardware, detached webbing, rotted structural components, air leaks, or nonfunctional oral inflation tube. Unless worn inflated, this PFD must also be properly armed with a full CO₂ cylinder, inflation system status indicator, and a manual inflation beaded handle accessible outside the user's right front panel cover (Fig. 1). The chest buckle, on the Inflatable Vest with LIFT™, must be fastened after inflation.

WHY ARE PFDs REQUIRED SAFETY EQUIPMENT?

Drownings are the leading cause of fatalities involving recreational and commercial vessels. A PFD provides flotation to help keep your head above water, help you to stay face up in the water, and increase your chances for survival and rescue. Most adults only need an extra 7 to 12 kg (3.2 to 5.5 pounds) of flotation to keep their heads above water. The proper size PFD will properly support the weight of the wearer.

Since this Inflatable PFD does not have inherent buoyancy, it provides flotation only when inflated. Familiarize yourself with the use of this

Inflatable PFD so you know what to do in an emergency.

WHAT IS AN INFLATABLE PFD?

Congratulations on the purchase of your Inflatable Vest with Patent Pending LIFT™ [Life-saving Inflatable Flotation Technology]. LIFT™ is different from all other inflatable PFD's. In general, inflatable PFD's are designed to suspend a user's head above water to prevent drowning. The Inflatable Vest with LIFT™ provides freeboard that far exceeds the minimal 3" generally provided. LIFT™ elevates you to an upright safe position and delivers up to 9" of freeboard, the highest ever seen in a PFD, keeping your mouth high above the water line to minimize the risk of mouth immersions. Not only is LIFT™ one of the world's best performing PFD's in wave conditions, but it's comfortable too. Light and ergonomically designed – you can't even tell you're wearing it until you need it.

While traditional PFDs are inherently buoyant, inflatable PFDs like the Inflatable Vest with LIFT™ rely entirely upon inflation for buoyancy. Uninflated, the Inflatable Vest with LIFT™ is comfortable and can be inflated at any time with a 38-gram CO₂ gas cylinder. The Inflatable Vest with LIFT™ is designed to meet the demands of a full protection PFD offering maximum mobility with minimum bulk. The Inflatable Vest with LIFT™ can be inflated either automatically during immersion, manually by pulling a beaded handle, or by mouth. It is imperative that you familiarize yourself with the procedures outlined in INSTRUCTIONS FOR USE (p. 3).

INSTRUCTIONS FOR USE

This manual supplies instructional, maintenance and safety information for model MD0450 22 unless specified otherwise. The model number is listed on the label.

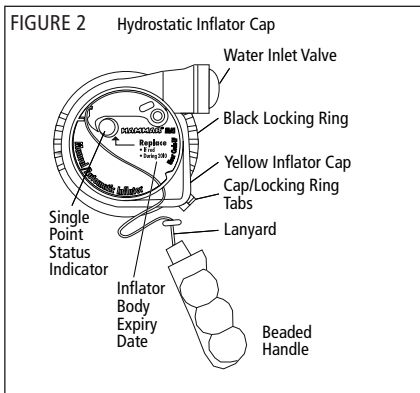
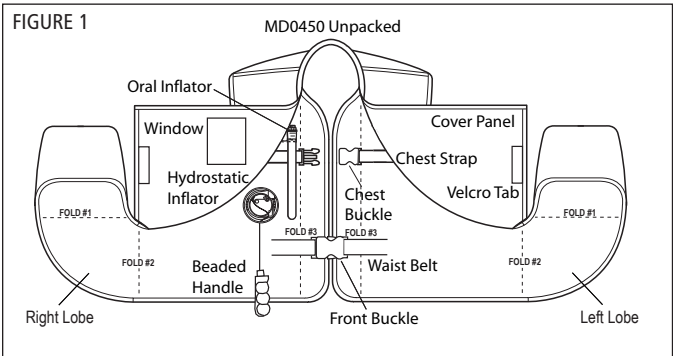

Component Inspection Instructions

- 1) Examine the single point indicator through the window panel. Ensure the single point indicator is green. If the single point indicator is red, the mechanism has been fired or is incorrectly fitted (Fig. 2). See

RE-ARMING YOUR PFD (p. 11).

NOTE: The single point indicator must be green before proceeding.

- 2) Open the cover at wearer's right-hand side of the chest and lay the device flat.
- 3) Ensure the oral-inflation dust cap is in the stowed position (Fig. 22).
- 4) Ensure the single point indicator is green and the beaded handle is attached to it's Velcro tab; secure the zippers on the Inflatable Vest with LIFT™ (see Repacking, p. 17).
- 5) Ensure the date on the inflator is not five years or older (Fig. 2). If it is, replace the inflator (see Re-arming Your PFD, p. 11).

Readiness Checklist

Check your Inflatable Vest with LIFT™ and ensure all of the checkpoints listed below are true before each use.

- Single point indicator is green.
- Ensure the current date is not past the date on the inflator. If it is, replace the inflator (see Re-arming Your PFD, p. 11).
- All zippers, Velcro™ and waist buckle are securely fastened.
- Inflatable Vest with LIFT™ is not twisted.
- Oral-inflation dust cap is in the stowed position (Fig. 22).
- Ensure the beaded handle is placed through the opening and is attached to the Velcro tab on the outside of the vest (Fig. 35).
- No rips, tears or holes; all seams are securely sewn; and the fabric, straps and hardware are still strong.

Your Inflatable Vest with LIFT™ is ready for use if all boxes are checked.

NOTE: Contact your Mustang Dealer if you have any concerns about the readiness of your Inflatable Vest with LIFT™.

Donning Instructions

It is important that the PFD is properly adjusted to fit the person wearing it. An incorrect fit or improper fastening of attachments could reduce its effectiveness.

- 1) Put the Inflatable Vest with LIFT™ on just like a jacket (Fig. 3). If the Inflatable Vest with LIFT™ is already inflated prior to donning, it may be excessively tight while donning. If so, expel some air by depressing the oral tube valve, don the Inflatable Vest with LIFT™, and refill Inflatable Vest with LIFT™ by mouth using the oral tube.
- 2) Fasten the front waist belt buckle (Fig 3). Adjust the waist belt to a secure fit using the front adjuster on the belt.

WARNING: Do not wear the Inflatable Vest with LIFT™ under other clothing or harness systems as the inflation could be restricted and you could be injured.

FIGURE 3

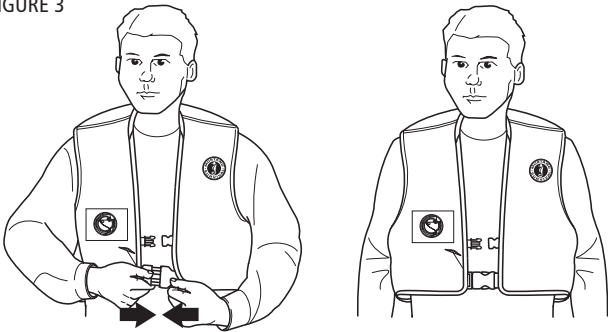

NOTE: Heavy objects in the pockets may cause the PFD to sink if dropped overboard when not inflated.

- 3) Fasten the middle buckle (Fig. 4). Adjust the middle belt to a secure fit using the front adjuster on the belt.

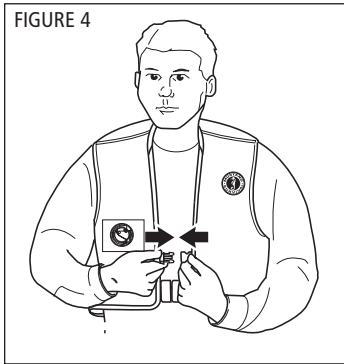

IMPORTANT: Ensure the chest buckle is fastened, when inflated (Fig. 4).

- 4) Feed the loose end of the waist belt into the belt opening in the storage pocket (Fig. 5).

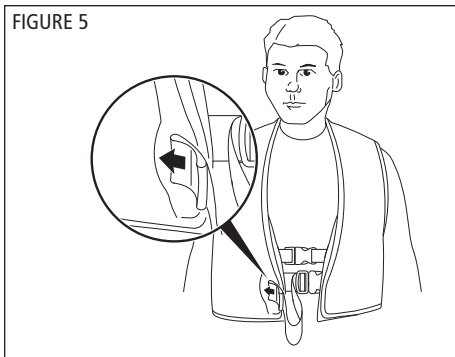

Inflation

It is recommended that the following procedures be followed to inflate your Inflatable Vest with LIFT™.

Manual Inflation

- 1) Activate the inflation system by grasping the beaded handle and jerk

firmly downward. The PFD should fully inflate within 5 seconds (Fig. 6).

NOTE: Deflation may occur if the CO₂ cylinder is removed while the Inflatable Vest with LIFT™ is inflated.

FIGURE 6

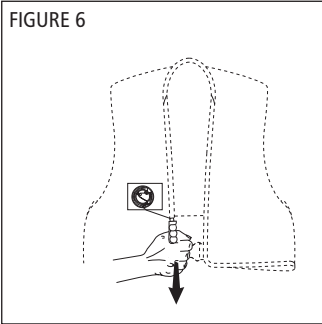

2) Fasten the chest straps (Fig. 7) and adjust to a snug fit.

Important: Ensure the chest buckle is fastened, when inflated.

FIGURE 7

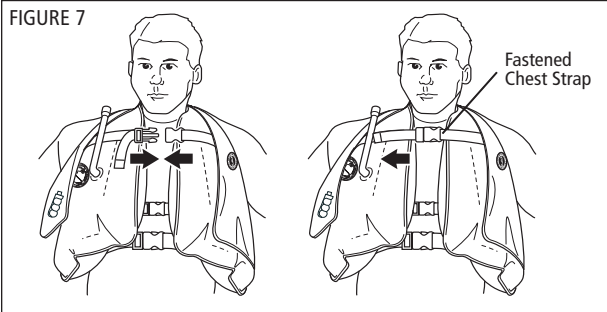

Automatic Backup Inflation

Inflation will occur automatically within 5 seconds after the inflator is immersed in water. Hydrostatic pressure opens the water inlet valve allowing the water-sensing element to disintegrate, triggering a spring-loaded plunger, which punctures the CO₂ cylinder inflating the Inflatable Vest with LIFT™ (Fig. 7).

NOTE: Hydrostatic inflator must be submerged in at least 4 inches of water to activate the inflator.

NOTE: When inflated, the carbon dioxide (CO₂ gas) used to inflate PFDs will slowly escape through the cell over time. A slight reduction of pressure will be observed after several hours of inflation. Topping up by oral inflation may be required in the event of prolonged immersion.

Oral Inflation

Properly armed and inspected Inflatable Vest with LIFT™ PFDs will inflate when manually or automatically activated. However, you can fully inflate the PFD by mouth (Fig. 8) should inflation not occur, or if you are in a non-emergency situation.

To orally inflate the PFD, first locate the oral inflation tube by opening the wearer's right front panel cover of the PFD. Then remove the dust cap from the end of the oral tube and blow into the tube until the PFD is fully inflated.

It may be necessary to manually release the Velcro™ tabs, located at the bottom of the left and right panel covers, for full inflation because oral inflation may not provide sufficient pressure to open the tabs.

CAUTION: CO₂ inflation could over-pressurize and damage your PFD if already orally inflated.

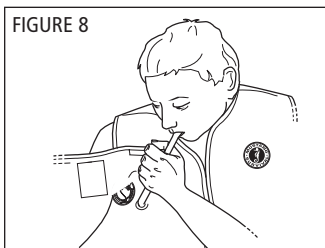

In-water Adjustments

Follow these instructions to adjust the waist belt, when wearing the Inflatable Vest with LIFT™ in the water.

To tighten:

- a. Grasp the loose end with the left hand. Pull the webbing to your right side (away from the buckle) (Fig. 9).
- b. Simultaneously grasp the waist belt along the body with the right hand (approximately 6 inches to the right of the buckle), and feed the webbing into the buckle.

FIGURE 9

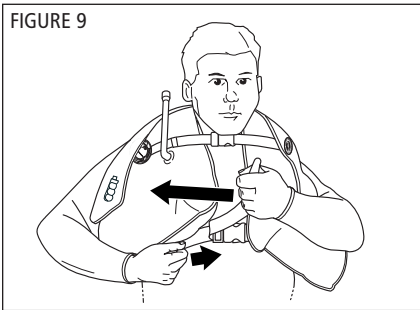

To loosen:

- a. Simultaneously grasp and hold the waist belt with the left hand as you grasp the lobe on the right side with the right hand and pull away from the center (Fig. 10).

FIGURE 10

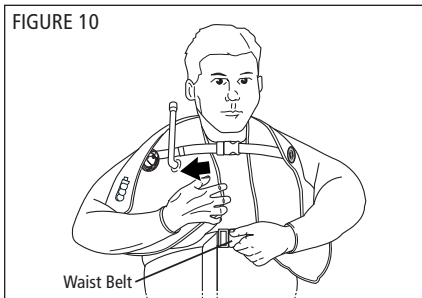

Special Considerations for Automatic Devices

The PFD might not be armed when needed, either knowingly or unknowingly. Premature automatic inflation causes several risks that you must address to avoid drowning. Much less common but also important are:

- 1) Double inflation (CO₂ cylinder inflation after full oral inflation) could damage the PFD,
 - 2) Inflation when stored in a tight space could damage the PFD, and
 - 3) The PFD could inflate when you are in an awkward place or position.
- If this PFD should inflate, a re-arm kit (MA7218-22), with a valid install-by-date, is required to re-arm the device.

IMPORTANT: The PFD should be re-armed according to the Re-arming Your PFD instructions (p. 11).

Deflation

- 1) To deflate the Inflatable Vest with LIFT™, reverse the oral inflation tube dust cap and insert it into the valve or depress valve with a fingertip. The dust cap will not lock in the deflate position so it is necessary to hold it in place (Fig. 11).
- 2) Gently squeeze the Vest until all air or gas has been expelled (Fig. 11). Do not ring or twist (see Re-arming Your PFD (p. 11) and Repacking (p. 17) sections of this manual).

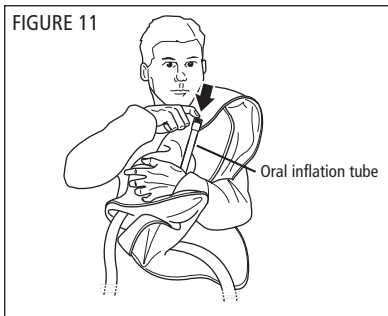

Usage Below Freezing

When the temperature is below freezing, a fully discharged cylinder may not adequately inflate your Inflatable Vest with LIFT™. Under these conditions use the oral inflator to top-up the Inflatable Vest with LIFT™.

It may be necessary to manually release the Velcro™ tabs, located at the bottom of the left and right panel covers, for full inflation because oral inflation may not provide sufficient pressure to open the tabs.

Re-arming Your PFD

NOTE: A valid re-arm kit (MA7218-22) is required for this procedure.

- 1) Place the Inflatable Vest with LIFT™ on a smooth, flat surface and wipe off any water. Access the inflator by reaching under the cover and fully expose the inflator for re-arming. Hold the CO₂ cylinder through the fabric, using one hand (Fig. 12).

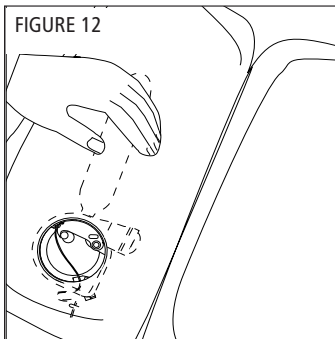

- 2) Insert the metal key between the black locking ring and labeled yellow cap. Turn the key counter-clockwise (Fig. 13).

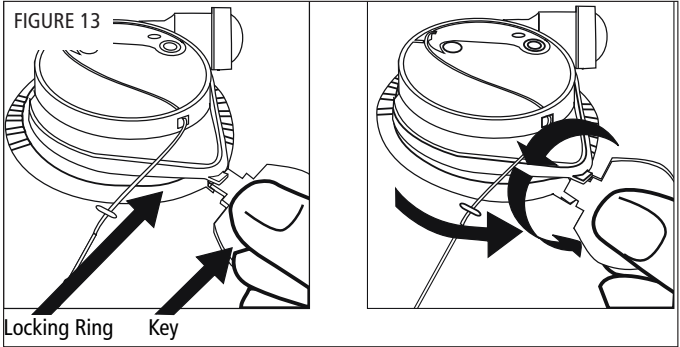

- 3) Turn the black locking ring counter-clockwise and lift off the cap (yellow inflator operating head Fig. 14). Dispose of the used cap.

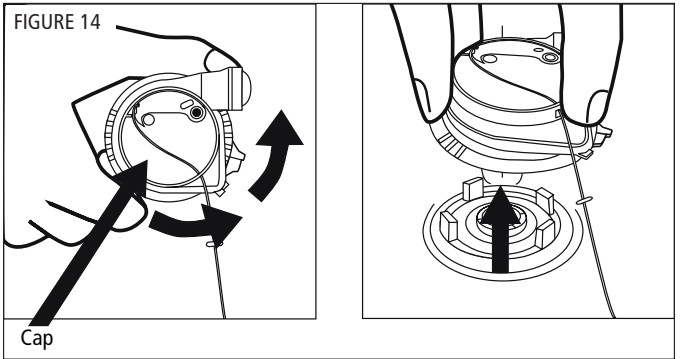

- 4) Squeeze the sealing ring to elongate and remove the inflator body (Fig. 15).

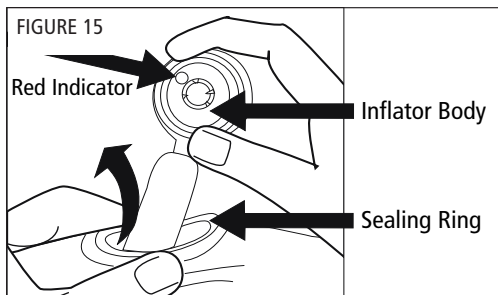

5) Dispose of the used inflator body.

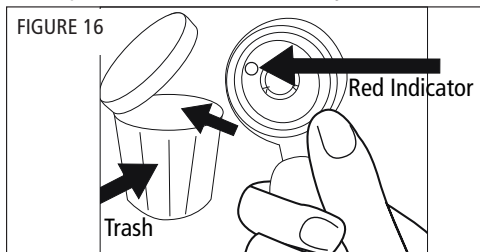

6) Check that the new inflator body indicator is green. Insert the new inflator body with CO₂ cylinder pointing upward inside the Inflatable PFD (Fig. 17). Let the sealing ring rest on the adapter around the four lugs.

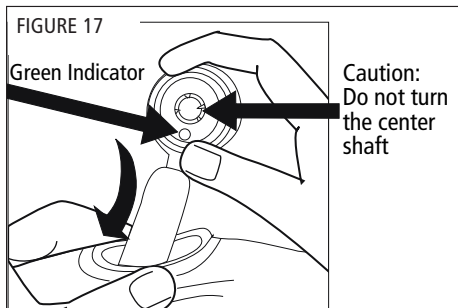

7) Now check the new manual/automatic cap as follows (Fig. 18):

1. Is the single point status indicator showing green?
2. Is the expiry day OK?

If YES is the answer to both questions, then proceed as follows. If the answer is NO to either question, get a new cap.

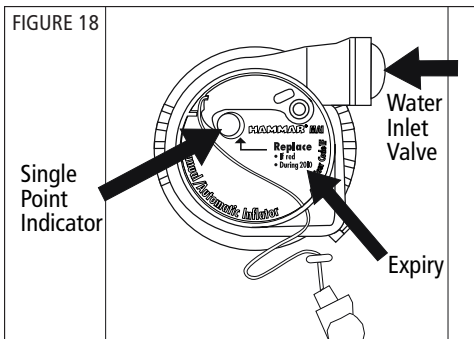

8) Hold the CO₂ cylinder through the fabric of the Inflatable Vest with LIFT™ (Fig. 19). Position the replacement cap with the water inlet valve pointing to the right and press firmly onto the inflator body and sealing ring (Fig. 20).

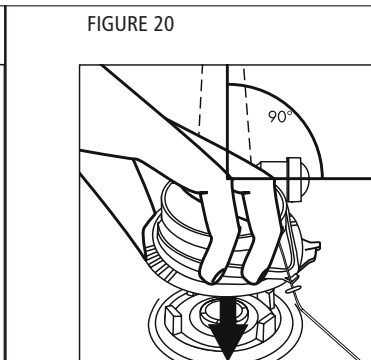
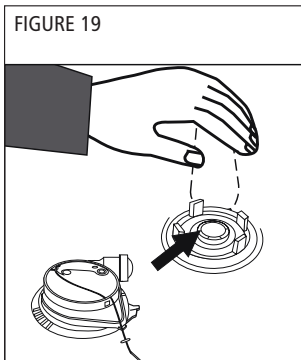

- 9) While pressing **FIRMLY** onto the inflator body, turn the **BLACK** locking ring clockwise into the locked position (Fig. 21). Pull on the cap to make sure it has locked onto the inflator body.

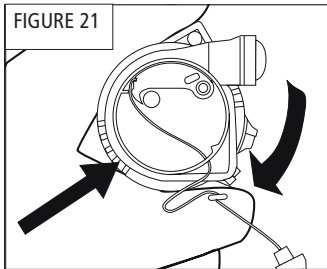

- 10) **Check:** To see that the single point status indicator on the cap is green; the pull to inflate lanyard is present and that the locking ring is locked.
- 11) Ensure the beaded handle is fed through the pocket opening and fastened to the Velcro tab (Fig. 39).
- 12) Refold the Inflatable Vest with LIFT™ in accordance with the Repacking section (p. 17).

Auto/Manual Conversion Cap (MA7219) Instructions

These instructions apply only when the MA7219 is used with a MD0450 22 with an armed Hammar M1 inflator - green status indicator.

CONVERSION INSTRUCTIONS

This will convert the MD3196 from an automatic inflation device to a manual inflation device. The device may be changed back to an automatic inflation device by removing the conversion cap.

CAUTION: A manual inflation device will not inflate on water contact unless the wearer activates the inflator.

- 1) Completely unzip the right lobe zipper (inflator side).

- 2) Fasten, by tying, the conversion cap lanyard to the loop in the pocket immediately in front of the inflator after passing it through the opening in the cover (Fig.22).

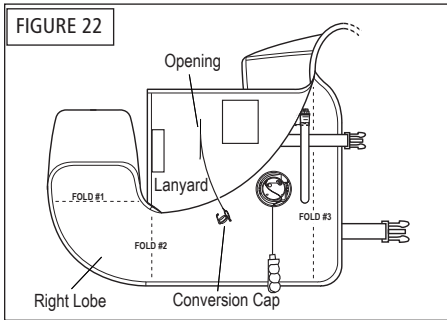

- 3) Position the conversion cap over the inflator's hydrostatic valve opening. The conversion cap's metal clip should be placed along the top of the inflator's hydrostatic valve (Fig.23).

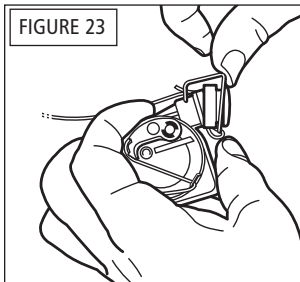

- 4) Secure the conversion cap to the inflator's hydrostatic valve by applying pressure to the cap, at the metal clip.

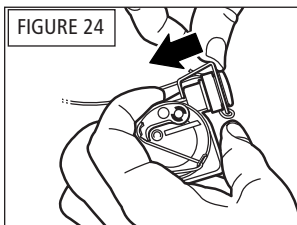

CONVERSION CAP REMOVAL

Once the conversion cap is removed, the MD3196 becomes an automatic inflation device. Firmly pull the conversion cap lanyard to remove the conversion cap (Fig.25).

NOTE: Do not pull inflation lanyard when removing conversion cap

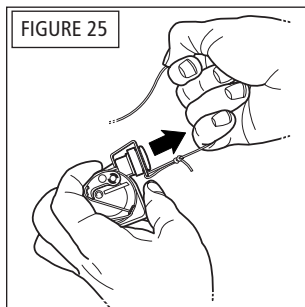

To remove the conversion cap when packed, pull the conversion cap lanyard out from the opening of the cover of the LP's right lobe. Visually confirm the conversion cap has been removed from the valve opening.

Place the conversion cap in the anti-chafing cover, in the front pocket, when not in use.

Repacking

IMPORTANT: Carefully read the entire Repacking instructions to achieve a properly packed Inflatable Vest with LIFT™

If your Inflatable Vest with LIFT™ has been used and/or the hydrostatic inflator replaced, always inflate through the oral tube and check that it stays inflated at least overnight. With the dust cap in the top of the oral tube, gently squeeze the Inflatable Vest with LIFT™ until all air or gas has been expelled (Fig. 11). Do not wring or twist the Inflatable Vest with LIFT™. Put the oral tube dust cap back in its stowed position on the oral tube (Fig. 26). Let the life jacket dry before packing.

1) Before repacking:

Completely deflate the Inflatable Vest with LIFT™ (see Deflation p. 10).

NOTE: Before following the repacking sequence, be sure to properly re-arm your Inflatable Vest with LIFT™ See Re-arming Your PFD (p.11).

2) Ensure the oral-inflation dust cap is fitted in the stowed position (Fig. 26).

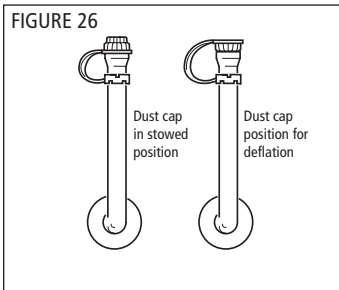

3) Open **both** front panel covers. Adjust the waist belt and chest belt buckles to their **full lengths** so that the Inflatable Vest with LIFT™ is laid out flat (Fig. 27 shows the right lobe, as worn).

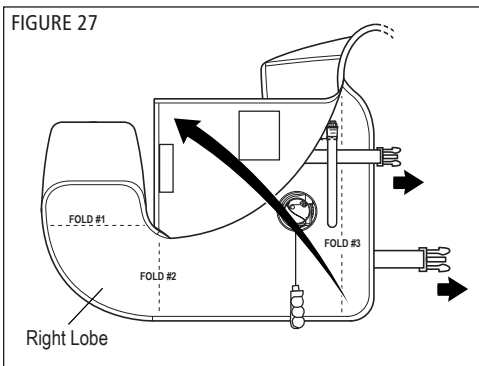

- 4) Lay out flat the right lobe (as it is worn). Shift the left lobe (as it is worn) on the waist belt to fully extend the right lobe for folding.

NOTE: The numbered fold lines, on the diagram, are provided to assist with packing. Make each fold towards yourself.

- 5) Fold the right lobe (as it is worn) over on the Fold #1 dashed line (Fig. 28). Note that the right lobe has the inflator with cylinder.

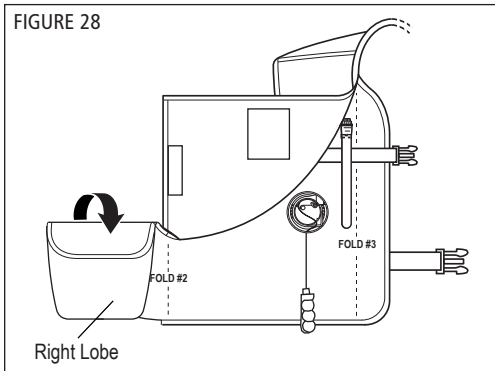

- 6) Continuing with the right lobe, fold it over on the Fold #2 dashed line (Fig. 29). Ensure that the bladder is tucked under the inflator to prevent it from blocking the indicator window (Point A).

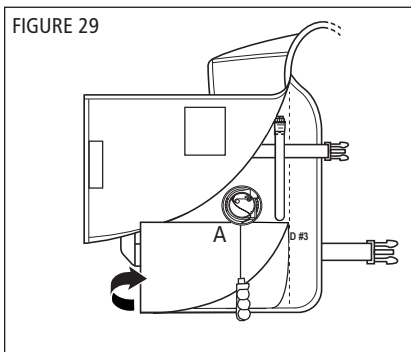

- 7) Fold the bottom portion of the lobe over (Fig. 30).
 - a. Position the lobe so it does not cover the inflator (Point A).
 - b. Put the inflator beaded handle through the opening in the cover (Point B) and attach to the Velcro tab.
 - c. Position the chest buckle under the cover (Point C).

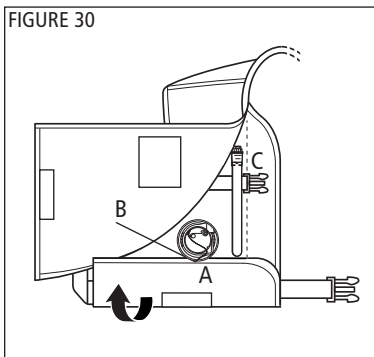

- 8) Fold the lobe over on the Fold #3 dashed line (Fig. 31).
 - a. Position the folded lobe so it **does not** cover the inflator (Point A).

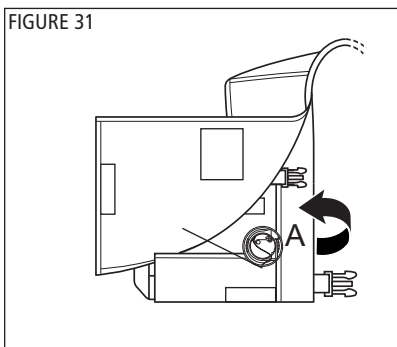

- 9) Fold the cover panel down so that it covers the lobe (Fig. 32).

FIGURE 32

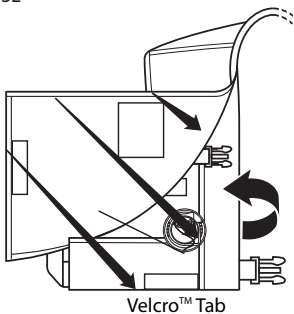

10) Mustang Survival uses advanced 2-step zippers - SecureZIP™. Find the right zipper tail on the right lobe and **ZIP 1 - Reset** the 2-step zipper by pulling the slider to the Velcro™ tab (Figs. 33 and 34).

NOTE: Fasten the Velcro™ tab to prevent the zipper from re-opening.

ZIP 2 - Close by pulling slider in the opposite direction to the end the zipper (Fig. 34). Ensure that the Inflatable cell does not get caught by the zipper when closing.

FIGURE 33

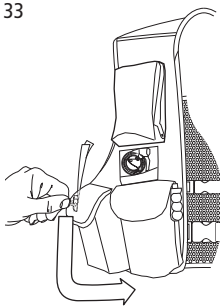
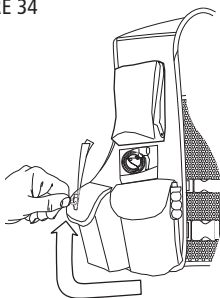

FIGURE 34



11) Find the left zipper tail on the right lobe and **ZIP 1 - Reset** the 2-step zipper by pulling the slider to the Velcro™ tab (Fig. 35).

NOTE: Fasten the Velcro™ tab to prevent the zipper from re-opening.

ZIP 2 - Close by pulling slider in the opposite direction to the end the zipper (Fig. 36). Ensure that the Inflatable cell does not get caught by the zipper when closing.

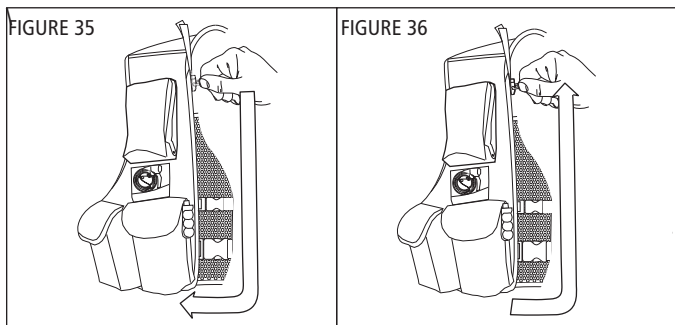

12) Tuck in the zipper tail, so it is not exposed (Fig. 37).

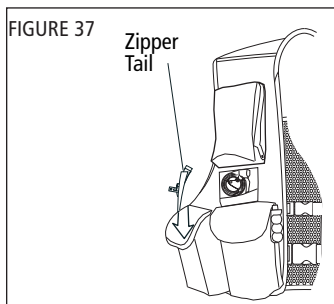

13) The right lobe should now be fastened closed and the inflator should be visible through the clear window. Ensure the beaded handle is placed through the opening and is attached to the Velcro tab on the outside of the vest (Fig. 39). Ensure the zipper is closed to the stop, located under the Velcro tab.

NOTE: Ensure the chest buckle does not extend outside of the

lobe, it should sit under the cover.

- 14) Repeat steps 3-12 for the left lobe (as it is worn). Note that the left lobe does not have an inflator or indicator window.
- 15) Turn over the Inflatable Vest with LIFT™ and fold the back flap up and fasten the three (3) Velcro™ tabs (Fig. 38).

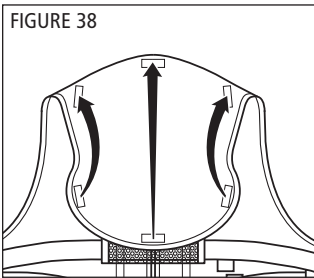

- 16) Use the adjustable waist belt to size to fit. When complete, the garment should appear as shown (Fig. 39) and be secure for use or storage.

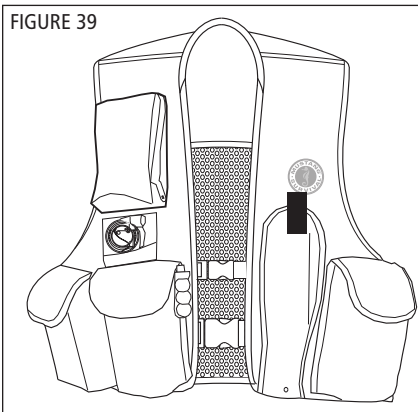

IS YOUR PFD IN GOOD AND SERVICEABLE CONDITION?

Check your PFD between outings to be sure that it is properly armed, as shown by green single point indicator; that it is free of rips, tears or holes; that all seams are securely sewn; and that the fabric, straps and hardware are still strong. Inspect the inflatable portion of the PFD in accordance with the CARE AND MAINTENANCE INSTRUCTIONS (p. 24).

CARE AND MAINTENANCE INSTRUCTIONS

It is the responsibility of the wearer to be sure this PFD is in serviceable condition. To be considered serviceable, this PFD shall not exhibit deterioration that could diminish its performance, such as broken or deformed hardware, detached webbing, rotted structural components, air leaks or nonfunctional inflators. Unless worn inflated, this PFD must also be properly armed with a cylinder installed in the inflator, and single point status indicator showing green. See Page 3 for instructions. Failure to follow these instructions rigorously could result in a non-functioning PFD causing injury or death.

Check the following at the intervals listed below.

1) Before Each Use:

- i) Examine the single point status indicator through the window panel, ensuring it is green. If the indicator is red, the mechanism requires service. See Re-arming Your PFD, p. 11.
- ii) Ensure the manual beaded handle is accessible.
- iii) Visually examine your Inflatable Vest with LIFT™ for damage or excessive abrasion, wear, tear or contamination. Particular attention must be paid to the stitching, straps and hardware. If in doubt, send it to your Mustang dealer for evaluation and/or servicing.

2) Every Six (6) Months:

- i) Leak Test: The Inflatable Vest with LIFT™ should be tested for general leakage by orally inflating your Inflatable Vest with LIFT™

until firm and let stand 2 hours. A leaking Inflatable Vest with LIFT™ will not hold its firmness and should be replaced. If your Inflatable Vest with LIFT™ leaks, take it to your Mustang dealer for evaluation and/or servicing. Repack the Inflatable Vest with LIFT™ as outlined in the Repacking section (p. 17).

ii) Oral Inflation Valve Test: To check the oral inflation valve, fully inflate the Inflatable Vest with LIFT™ using the oral inflator and hold valve under water. If bubbles appear, deflate and re-inflate to test again. Should the leak persist, take your Inflatable Vest with LIFT™ to your Mustang dealer for evaluation and/or servicing.

CAUTION: To avoid accidental inflation, don't allow the water to contact the hydrostatic inflator.

iii) Perform a thorough visual examination. See **Readiness Checklist** (p. 4).

Perform these tests more often if exposed to potential damage or used in extreme conditions.

3) **After Each Inflation** - Re-arm the Inflatable Vest with LIFT™. See Re-arming Your PFD, p. 11.

4) **Annually** - Perform the following at the beginning of each boating season, after inflation, or whenever the integrity of the Inflatable Vest with LIFT™ is in doubt:

i) Check all components for dirt or corrosion. Clean or replace, as necessary. See **Readiness Checklist** (p. 4).

ii) Visually examine your Inflatable Vest with LIFT™ for damage or excessive abrasion, wear, tear or contamination. Particular attention must be paid to the stitching, straps and hardware. If in doubt, send it to your Mustang dealer for evaluation and/or servicing.

iii) Perform the Leak Test. See the Leak Test (section 2) i) in the Care and Maintenance Instructions).

iv) Perform the Oral Inflation Valve Test: See the Oral Inflation Valve Test (section 2) ii) in the Care and Maintenance Instructions).

v) Ensure the current date is not past the date on the inflator. If it is, replace the inflator (see Re-arming Your PFD, p. 11).

vi) Ensure the single point status indicator is green (Fig. 2).

Repack the Inflatable PFD as outlined in the Repacking section (p. 17).

WARNING: If you are not confident in the self-inspection and servicing of your Inflatable Vest with LIFT™ in accordance with these instructions, take your Inflatable Vest with LIFT™ to a Mustang dealer for professional servicing or contact Mustang Survival (see contact information on back of manual).

Cleaning and Storing

To avoid inflation, do not submerge the Inflatable Vest with LIFT™ or directly spray the inflator. Hand wash or sponge down the Inflatable PFD in warm, soapy water. Rinse the PFD and inflator with clean water, using a clean rinse cloth. Hang the Inflatable Vest with LIFT™ to dry on a plastic coat hanger. Do not dry clean.

Always store your Inflatable Vest with LIFT™ in a warm, dry place out of direct sunlight.

HOW AND WHY TO TEST YOUR PFD

Inflate your Inflatable Vest with LIFT™ and try it out in the water to:

- Make sure it floats you:
 - Comfortably (when worn properly)
 - Adequately for expected wave conditions (body shapes/densities affect performance)
- Make sure it works:
 - A flow of bubbles should not appear (see CARE AND MAINTENANCE INSTRUCTIONS for leak tests p. 24). It should inflate quick and easily.
- Learn how it works by:

- Activating the CO₂ inflation system
- Re-arming the CO₂ inflation system
- Using the oral inflator tube

HOW DO YOU TEST YOUR PFD USING THE AUTOMATIC INFLATOR?

- 1) To test your Inflatable Vest with LIFT™, you will need your fully armed Inflatable Vest with LIFT™, and re-arming kit (MA7218-22) approved for your Inflatable Vest with LIFT™.
- 2) Put on the Inflatable Vest with LIFT™.
- 3) Get into shallow water, just deep enough that you can stand with your head above the surface. Once the inflator is underwater, 4 inches or so, the Inflatable Vest with LIFT™ should fully inflate automatically within 5 seconds.
- 4) See if the Inflatable Vest with LIFT™ will float you on your back or just slightly back of vertical. In a relaxed floating position, verify that your mouth is well above the water's surface. Note the effect of where you hold your legs on how you float.
- 5) Get out of the water and remove the Inflatable Vest with LIFT™.
- 6) Deflate the Inflatable Vest with LIFT™ by depressing the oral inflator valve (see Deflation p. 10). Remove the used inflator.
- 7) Let the Inflatable Vest with LIFT™ dry thoroughly. Re-arm (p. 11) and Repack the PFD (p. 17).

HOW DO YOU TEST YOUR PFD USING THE MANUAL INFLATOR?

- 1) To test your Inflatable Vest with LIFT™, you will need your fully armed Inflatable Vest with LIFT™, and re-arming kit approved for your Inflatable Vest with LIFT™: MA7218-22.
- 2) Put on the Inflatable Vest with LIFT™.

- 3) Actuate the inflation system by jerking firmly downward on the beaded handle. The Inflatable Vest with LIFT™ should fully inflate within 5 seconds.
- 4) Get into shallow water, just deep enough that you can stand with your head above the surface.
- 5) See if the Inflatable Vest with LIFT™ will float you on your back or just slightly back of vertical. In a relaxed floating position, verify that your mouth is well above the water's surface. Note the effect of where you hold your legs and how you float.
- 6) Get out of the water and remove the Inflatable Vest with LIFT™. Completely deflate the Inflatable Vest with LIFT™ using the oral inflator (see Deflation p. 10).
- 7) Let the Inflatable Vest with LIFT™ dry thoroughly. Re-arm (p. 11) and Repack the PFD (p. 17).

HOW DO YOU TEST YOUR PFD USING THE ORAL INFLATOR?

This test is not mandatory, however may be conducted using the following procedure.

WARNING: Use only a previously fired hydrostatic inflator to perform this test. DO NOT test with a fully armed hydrostatic inflator as double inflation may occur, possibly resulting in cell damage.

- 1) No spare parts or re-arming kits are needed to test your Inflatable PFD.
- 2) Put on the Inflatable Vest with LIFT™.
- 3) Get into shallow water, just deep enough that you can stand with your head above the surface.
- 4) If you are a weak swimmer or non-swimmer, inflate the Inflatable Vest with LIFT™ partially so that you are supported well enough to

be able

to complete inflation without touching bottom, either orally or manually. Note this level of inflation because it is the minimum needed for you to safely use this Inflatable Vest with LIFT™.

- 5) Fully inflate the Inflatable Vest with LIFT™ using the oral inflator. It may be necessary to manually release the Velcro™ tabs for full inflation because oral inflation may not provide sufficient pressure to open the tabs.
- 6) See if the Inflatable Vest with LIFT™ will float you on your back or just slightly back of vertical. In a relaxed floating position, verify that your mouth is well above the water's surface. Note the effect of where you hold your legs and how you float.
- 7) Get out of the water and remove the Inflatable Vest with LIFT™. Completely deflate the Inflatable Vest with LIFT™ using the oral inflator (see Deflation p. 10).
- 8) Let the Inflatable Vest with LIFT™ dry thoroughly. Re-arm (p. 11) and Repack the PFD (p. 17).

Re-assemble inflation system parts and repack the Inflatable Vest with LIFT™.

WEAR YOUR PFD

In approximately 80 percent of all boating fatalities, the victims were not wearing a PFD. Most fatal accidents happen on calm sunny days. This inflatable PFD is much more comfortable to wear than other PFD types. Get into the habit of wearing this PFD.

Non-swimmers and children especially should wear a hybrid or non-inflatable PFD at all times when on or near the water.

HYPOTHERMIA

Prolonged exposure to cold water causes a condition known as hypothermia – a substantial loss of body heat, which leads to exhaustion and unconsciousness. Most drowning victims first suffer from hypothermia. The following chart shows the effects of hypothermia: how hypothermia affects most adults.

How hypothermia affects most adults

Water Temperature °C (°F)	Exhaustion or Unconsciousness	Expected Time of Survival
0.3 (33)	Under 15 min.	Under 15–45 min.
0.3–4 (33–40)	15–30 min.	30–90 min.
4–10 (40–50)	30–60 min.	1–3 hrs
10–16 (50–60)	1–2 hrs.	1–6 hrs.
16–21 (60–70)	2–7 hrs.	2–40 hrs.
21–27 (70–80)	2–12 hrs.	3 hrs. to Indefinite
Over 27 (over 80)	Indefinite	Indefinite

PFDs can increase survival time because they allow you to float without using energy treading water and because of their insulating properties. Naturally, the warmer the water, the less insulation you will require. When operating in cold waters [below 60°F (15.6°C)] you should consider using a coat or jacket style PFD or a Type V Thermal Protective PFD as they cover more of the body than the vest or belt style PFDs. Some Points to Remember About Hypothermia Protection:

- 1) Always wear your PFD. Even if you become incapacitated due to hypothermia, the PFD will keep you afloat and greatly improve your chances of rescue.
- 2) Do not attempt to swim unless it is to reach a nearby craft, fellow survivor, or a floating object on which you can lean or climb. Swimming increases the rate of body heat loss. In cold water, drown-proofing methods that require putting your head in the water are not recommended. Keep your head out of the water. This will greatly

lessen heat loss and increase your survival time.

- 3) Use the standard H.E.L.P. position when wearing an inflatable PFD, drawing the legs up to a seated position, because doing so will help you conserve body heat (Fig. 36).
- 4) Keep a positive attitude about your survival and rescue. This will improve your chances of extending your survival time until rescued. Your will-to-live does make a difference!
- 5) If there is more than one person in the water, huddling is recommended while waiting to be rescued. This action tends to reduce the rate of heat loss and thus increase the survival time.

FIGURE 36



EACH OF THESE DEVICES IS INTENDED TO HELP YOU SAVE YOUR OWN LIFE

For your PFD to function properly, follow these suggestions to verify that it fits, floats, and remains in good condition.

- 1) Check the inflation mechanism status indicator before each use.
- 2) Get in the habit of re-arming the inflation mechanism immediately after each CO₂ inflation (be sure the inflator is dry before re-arming).
- 3) Try your wearable PFD on and adjust it until it fits comfortably in and out of the water.
- 4) Mark your PFD with your name if you are the only wearer.
- 5) Do not alter your PFD. If it doesn't fit properly, get one that does.
- 6) Your PFD is not intended for use as a fender or kneeling pad.

- 7) If your PFD is wet, allow it to dry thoroughly before storing it. Store it in a well-ventilated area.
- 8) Do not dry your PFD in front of a radiator or other source of direct heat.

SAFETY ACCESSORIES

For the MD0450 22 use a MA7218-22 Re-arm Kit, which includes a 38-gram CO₂ replacement cylinder, inflator body and beaded handle.

DO NOT ATTACH PFD'S TO YOUR BOAT

Each PFD has straps, hooks, buckles, or other means for securing the device in place on the wearer. Some PFDs also incorporate decorative D-rings or tabs. Such items are not to be used to attach the device to the boat. Attaching the device to the boat will not permit it to perform as intended.

AIRLINE OPERATOR POLICY ON CARRIAGE OF INFLATABLE PFDs AND CO₂ CARTRIDGES

Please be aware that the following regulations apply to the air transport of this product. According to U.S. Department of Transportation (DOT), PHMSA - the Pipeline and Hazardous Materials Safety Administration Title 49 CFR 75.10(a)(25): With the approval of the aircraft operator, one small carbon dioxide cylinder (not installed), plus one spare cartridge, may be carried by a passenger or crew as checked baggage.

Please refer to the governing body's documentation, found online at <http://www.phmsa.dot.gov/>



WE SAVE LIVES FOR A LIVING

www.mustangsurvival.com

3870 Mustang Way
Bellingham, WA
USA 98226

TOLL FREE
EMAIL
WEB

1.800.526.0532
mustangusa@mustangsurvival.com
www.mustangsurvival.com

Mustang Survival and seahorse design are registered trademarks of Mustang Survival Corp.

Our commitment to quality has earned our Richmond facilities ISO 9001 registration, the highest of all international standards. This is our guarantee you're receiving the ultimate in design and manufacturing.

Printed in Canada (Rev 30 Mar 07)